

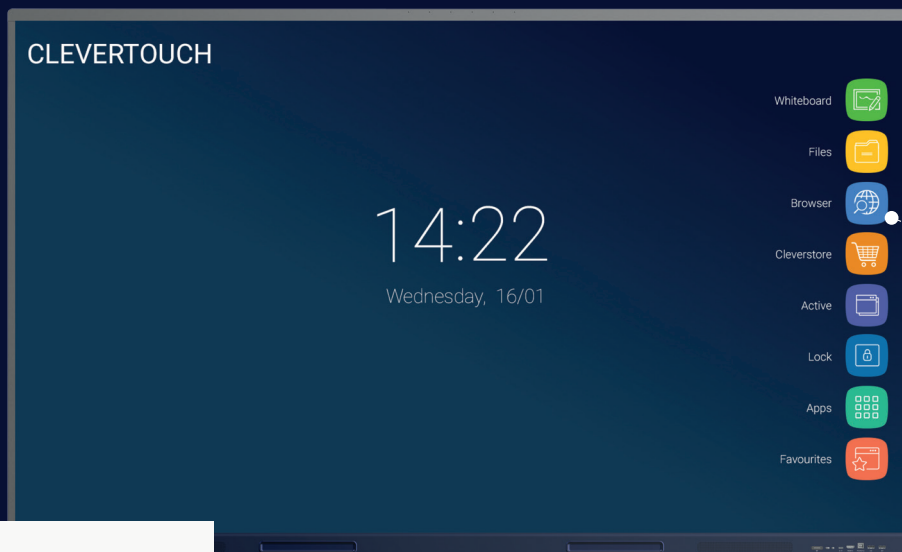

# IMPACT Max

Maximum security. Maximum potential. Maximum results.

Delivering a truly intuitive and collaborative experience, IMPACT Max is an interactive screen with unlimited possibilities. Combines high-quality design, functionality, durability, native screen sharing and 4K resolution.



**Quick Launch Menu for instant teaching tools**  
Your most commonly used apps are available with one touch and are easily accessible via the Quick Launch Menu.

Available in a range of sizes  
65" | 75" | 86"

Software included at no extra cost

**CLEVER® LIVE**  **CLEVERSHARE®**  **CLEVERMDM®**

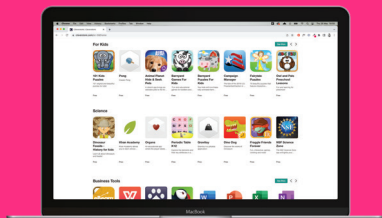

 **CLEVERSTORE®**

Choose from hundreds of apps at no extra cost. Cleverstore has apps in multiple languages and for all age groups and

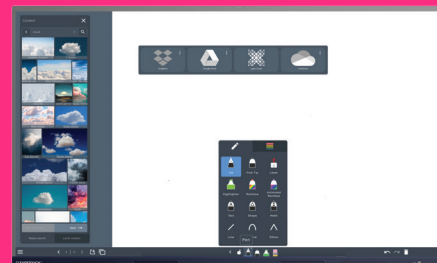

 **LYNX**  
whiteboard

LYNX Whiteboard is a free-to-use lesson building app, enabling student collaboration. The most dynamic,



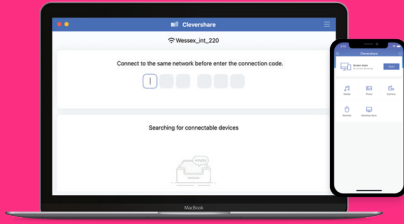

Any device can download the Clevershare app and connect instantly by typing in the code on the Clevertouch screen. Clevershare App is free to download and compatible with Android, Windows, iOS, and Chrome devices.

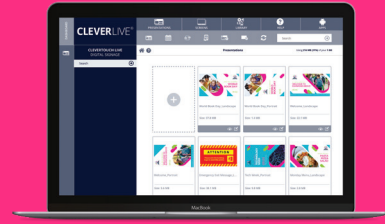

CleverLive controls all of your Clevertouch products from one central place. It is the software platform that enables the creation, deployment and management of content deployed across one or multiple displays. CleverLive is a cloud management platform and is compatible with any device.

## Key Features



Designed for blended learning



LYNX Whiteboard lesson creation app



Cleverstore free app store



Clevershare screen mirroring



Remote management MDM



Customise your home screen



Full digital signage capabilities



Microsoft

Compatible with Google Classroom and Microsoft 365



Connect your Cloud accounts to work from anywhere



Built-in array microphone - all lessons can be recorded with sound



Latest generation USB-C with charging and hardware optimization



2 x 20W speakers for room-filling sound



IMPACT Max is an Award-Winning Clevertouch Interactive Display.

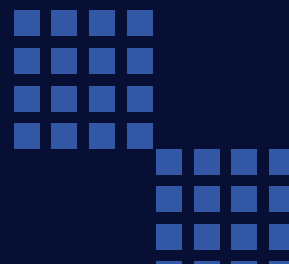

# IMPACT Max Specifications

## Display

<b>Diagonal Size</b>	65" 4K, 75" 4K, 86" 4K
<b>Screen Type</b>	TFT LCD - Direct LED Backlight
<b>Aspect Ratio</b>	16:9
<b>Display Colours</b>	1.07 Billion (10 bit)
<b>Resolution</b>	4K UHD (3840x2160 @60Hz)
<b>Response Time</b>	5ms
<b>Refresh Rate</b>	60Hz
<b>LCD Viewing Angle</b>	178°
<b>Brightness</b>	450 cd/m2
<b>Contrast Ratio</b>	65" 4000:1 75" 5000:1 86" 4000:1
<b>Dynamic Contrast Ratio</b>	65" 6000:1 75" 6000:1 86" 6000:1
<b>Glass Hardness</b>	Tempered Glass - Mohs Level 7
<b>Glass Thickness</b>	3mm
<b>Glass Type</b>	Low Parallax 1mm Air Gap - Heat tempered
<b>AntiGlare Glass</b>	Yes
<b>Main Board</b>	Amlogic T982 (SoC)
<b>Life of Screen</b>	50,000 Hours
<b>NTSC</b>	65" 72% 75" 72% 86" 68%

## Interactivity

<b>Writing Technology</b>	High Precision IR Technology
<b>Continuous Touch Points</b>	20
<b>Touch Resolution</b>	32768x32768px
<b>Response Time</b>	≤5ms
<b>Touch Accuracy</b>	1mm
<b>Minimum Object Size</b>	3mm
<b>Touch Tool</b>	Finger, passive pen, opaque objects
<b>Simultaneous Writing</b>	Yes
<b>Ink In Tools</b>	Yes - Lynx
<b>Pens Included</b>	2
<b>Pen Type</b>	Dual Recognition Stylus   Super Cool Stylus
<b>Pen Holder</b>	Integrated magnetic pen holders
<b>Pen Tip Diameter</b>	3mm/7mm
<b>Pen &amp; Touch Differentiation</b>	Yes
<b>Pen Identities</b>	2
<b>Palm Rejection</b>	Yes
<b>Annotation Over Any Source</b>	Yes
<b>Classroom Essential Apps</b>	Includes Whiteboard, Annotate, Timer, Media Players, Browser, PDF Reader, Screen Record, Spinner, Voting, Maths Tools
<b>Compatibility*</b>	Windows 10, Linux, Mac, Android, Chrome
<b>Tracking Rate</b>	≥1m/s
<b>Scan Rate</b>	200Hz
<b>Gestures &amp; Edge Swipes</b>	Windows Supported, OSX With additional Driver

## Connectivity

<b>OPS Slot</b>	1 - Intel Spec 80Pin
<b>HDMI In</b>	3
<b>HDMI Out</b>	1
<b>USB-A 2.0</b>	1
<b>USB Touch (type B)</b>	2
<b>USB A 3.0 (Faster Data Transfer)</b>	4
<b>USB C (Video, Audio &amp; Touch)</b>	1 (supports 65W charging)
<b>LAN In (RJ45)</b>	1 GB
<b>LAN Out (RJ45)</b>	1
<b>RS-232</b>	1
<b>Wake-on-Lan</b>	Yes
<b>Wireless Adapter 2.0 + WAP</b>	Yes
<b>Clevertouch WiFi Module</b>	Yes
<b>Bluetooth</b>	Yes 5.0
<b>Displayport In</b>	No
<b>VGA In</b>	1
<b>Audio In</b>	1
<b>Optical Out</b>	1
<b>Headphone</b>	1 (3.5mm)
<b>Total touch out ports</b>	2
<b>NFC Reader / Writer</b>	Optional Extra
<b>Camera</b>	Optional Extra
<b>Proximity Sensor</b>	No
<b>Array Mic</b>	6
<b>WiFi</b>	IEEE 802.11a/b/g/n/ac/ax with 2 × 2 MIMO (hotspot only) (both 2.4 and 5 GHz bands)
<b>WiFi Speed</b>	Capable of speeds up to 433Mbps

## Computing

<b>Operating System</b>	Android 11
<b>System Version</b>	LUX 11
<b>RAM</b>	8GB
<b>Internal Storage</b>	64GB
<b>CPU</b>	Quad Core A55
<b>GPU</b>	Mali G52MP2
<b>Android Resolution</b>	4K
<b>Android Module Slot</b>	No
<b>System Architecture</b>	32-bit
<b>Integrated LUX UI</b>	Yes

## Power

<b>Power Requirements</b>	100-240V ~ 50/60Hz
<b>Power Consumption (Standby)</b>	≤0.5W
<b>Ultra Quiet Fanless Design</b>	Yes
<b>Power Consumption</b>	65" 178 Watts 75" 183 Watts 86" 195 Watts

# IMPACT Max Specifications

## Audio

Dual Front Facing, Bass Enhanced Speakers	2 x 20W
Audio Out	Yes
SPDIF / Fibre	Yes
Sound Channel	2
Line Array Microphone	Yes
Super Wide Sound	No

## Operating & Storage Environment

Operating Temperature	0° to 40°
Storage Temperature	-20° to 60°
Operating Humidity	10% to 90% RH
Storage Humidity	10% to 90% RH
Altitude	Below 5000 metres

## Physical Spec

Panel Dimensions	65" 1489x906x87mm 75" 1709x1013x88mm 86" 1957x1168x88mm
Packed Dimensions	65" 1628x208x1005mm 75" 1863x225x1148mm 86" 2110x225x1291mm
Net Weight	65" 35.9kg 75" 47.75kg 86" 62.9kg
Packed Weight	65" 46.25kg 75" 61.9kg 86" 80.6kg
VESA Mount Point	65" 600x400mm 75" 800x400mm 86" 800x600mm

## Inside your Clevertouch Box

What's In The Box	(1) Clevertouch IMPACT MAX (1) 1.5M Length HDMI Cable (1) 3M Length USB cable (A-B) (1) 1.5M USBC Cable (1) 3M Regional Power Cable (1) Remote Control (2) Batteries for Remote Control (2) Dual Recognition Stylus (1) User Guide (1) Quick Install Guide (1) Clevertouch WiFi Module
-------------------	--

## IMPACT Max Built-In Features

LYNX™ App With Online Lesson Planning	Yes
Cleverstore™ App Store For Education	Yes
Embedded Digital Signage	Yes
Clevershare™ Mirroring Any Device To The Board	Free for the life of the screen (touch back)
Integrated Personalised Accounts Profiles	Yes
Cloud Account Access	OneDrive, Google Drive, LYNX Cloud
Embedded Room Booking	Yes
Whiteboard Annotation	Yes
Email Out Direct From Touchscreen	Yes
Scan QR Code For Saving Work	Yes
Alerts and Announcements	Yes
Over-the-Air Updates	Yes
Remote Management Of Touchscreens (MDM)	Yes - Five year license
CleverLauncher™	Yes
LynxShare™	Yes
LynxCloud™	Yes

## Warranty

Warranty term and upgrade options vary by region. Contact your local reseller or distributor for information and visit [clevertouch.com/about/warranty](http://clevertouch.com/about/warranty)

## Compliance & Certification

Regulatory Certification	CE, FCC, UL, Energy Star & EEC
--------------------------	--------------------------------



## Support

For all Clevertouch products, visit: [support.clevertouch.com](http://support.clevertouch.com)

## Statement

Size and weight vary by configuration and manufacturing process, please refer to the actual product. The product images are for illustrative purposes only and may slightly differ in appearance, colour, size, etc. from the actual product. The description, illustrations, etc. in this document may subject to change in accordance with the latest product specification and performance. Should the above-mentioned change in the document become necessary, the document may be updated without written notice.